

## SOCKET HUB ANCHORS

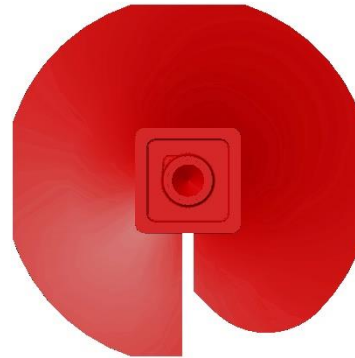
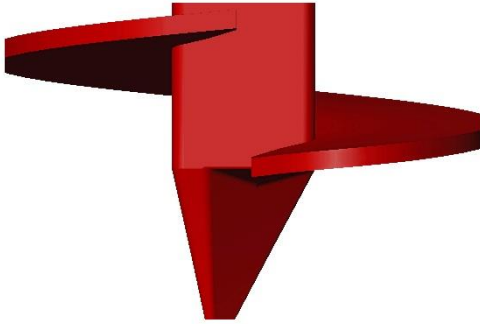

| 2-1/4" Socket Drive   |            | 10,000 ft-lb Torque Rating |        |
|---|------------|----------------------------|--------|
| Catalog Number  | Helix Thk. | Helix Dia                  | Thread |
| SD225-8-1   | .375       | 8                          | 1-8UNS |
| SD225-10-1  | .375       | 10                         | 1-8UNS |
| SD225-12-1  | .375       | 12                         | 1-8UNS |
| SD225-14-1  | .375       | 14                         | 1-8UNS |
| Anchor Coating: Painted<br>To specify helix with beveled edge, add suffix "V" |            |                            |        |

| 2-1/2" Socket Drive   |            | 15,000 ft-lb Torque Rating |        |
|---|------------|----------------------------|--------|
| Catalog Number  | Helix Thk. | Helix Dia                  | Thread |
| SD250-8-1   | .375       | 8                          | 1-8UNS |
| SD250-10-1  | .375       | 10                         | 1-8UNS |
| SD250-12-1  | .375       | 12                         | 1-8UNS |
| SD250-14-1  | .375       | 14                         | 1-8UNS |
| Anchor Coating: Painted<br>To specify helix with beveled edge, add suffix "V" |            |                            |        |